



Liquidator Zero-Loss Condensate Removal

The Liquidator is a pneumatically-powered zero-loss condensate removal solution. It uses a ball-float sensor to determine when the drain reservoir is full and open the drain valve. The Liquidator maintains a minimum liquid level within the reservoir to ensure that only condensate is removed from the system and that no process air escapes through the drain orifice.

Features



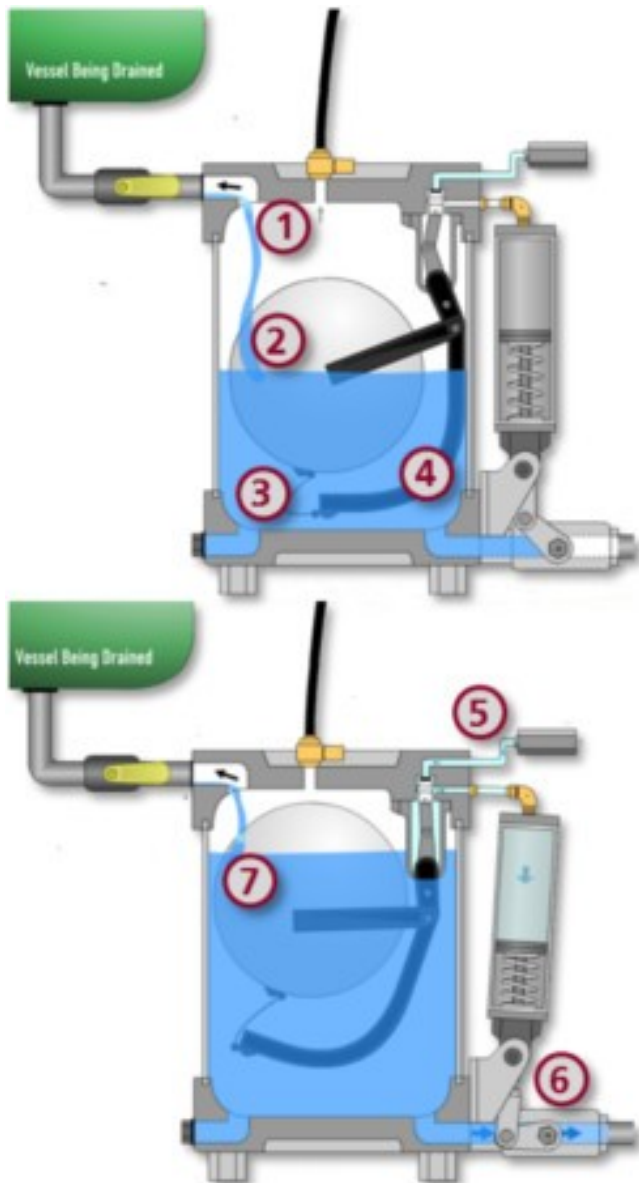

- As condensate enters accumulation reservoir, air returns to the system.
- Ball float rises as condensate accumulates in the reservoir.
- Float tether cable tenses as float rises.
- Linkage arm is pulled laterally by the tether cable
- Pilot air line is opened and pressurizes the piston cylinder.
- Pilot air compresses a pneumatic piston to open the discharge valve and drain condensate from the reservoir.
- Pilot air line closes and pneumatic piston retracts as float sinks.

Model Specifications

Attribute	Metric	Imperial
Weight	5 kg	11 lb
Reservoir Volume	1.54 L	52 oz
Volumetric Flow Rate	49.2 L/min	13.6 gal/min
Cycle Discharge Volume	1.3 L @ 7 barg	44 oz @ 100 psig
Fluid Port Size	15 mm	5/8 in.
Ball Valve Port Size	13 mm	1/2 in.
Allowable Fluid Temperature	1 to 65 C	34 to 150 F
Required Pilot Air Pressure	3.8 to 8.3 barg	55 to 120 psig
Max. Reservoir Pressure	17 barg	250 psig

Parts & Accessories



**ReliaDrain Zero-Loss
Condensate Removal**



**MSG® TURBO-AIR® Centrifugal
Compressor Replacement Parts**



Ingersoll Rand (NYSE:IR) advances the quality of life by creating comfortable, sustainable and efficient environments. Our people and our family of brands—including Club Car®, Ingersoll Rand®, Thermo King® and Trane®—work together to enhance the quality and comfort of air in homes and buildings; transport and protect food and perishables; and increase industrial productivity and efficiency. We are a \$14 billion global business committed to a world of sustainable progress and enduring results. For more information, visit www.ingersollrand.com.